



**STONE MARTIN
BUILDERS**

Contact Our Sales Associate

Rhonda Pitts

256.808.2250 |

susanlaughlin@stonemartinbuilders.com



326 St. Louis Street

Madison, AL 35758

Town Madison

\$479,900

Plan:Ethridge A (Lot 46)

SQ FT:2,046

Beds:3

Baths:2.0

Garage:2

ABOUT THIS HOUSE

The "Ethridge" plan offers a unique blend of an open-layout concept paired with a cozy, inviting feel. This plan provides a great room settled in the front of house, which allows convenient access to the front porch and two bedrooms. The two bedrooms are conjoined by a spacious bathroom, with comfort height vanities. The dining room, which is situation in the center of the house, leads directly into the kitchen and breakfast area, making entertaining a breeze. The kitchen provides easy access to the back deck. The master, located directly off the kitchen, creates an undisturbed environment in the back of the house. The master bedroom is completed with a luxurious master bathroom that includes a garden tub, his and her closets and elegant vanities. This plan includes a basement to add additional office, play or guest space.

...[Read More Online](#)

ABOUT TOWN MADISON

Town Madison is a 563-acre modern, walk-able, urban community that creates connectivity, community, and a cultural experience unique in North Alabama. It provides a new experience for living, shopping, working, dining, and entertainment by connecting people with their environment in a more meaningful way. Luxurious homes and a village square, with impeccable amenities, makes The Heights at Town Madison the most desirable place to call "home."

...[Read More Online](#)

Prices, plans, dimensions, features, specifications, materials, and availability of homes or communities are subject to change without notice or obligation. Illustrations are artists depictions only and may differ from completed improvements. All prices subject to change without notice. Please contact your sales associate before writing an offer.



STONE MARTIN
BUILDERS

Contact Our Sales Associate

Rhonda Pitts

256.808.2250 |

susanlaughlin@stonemartinbuilders.com

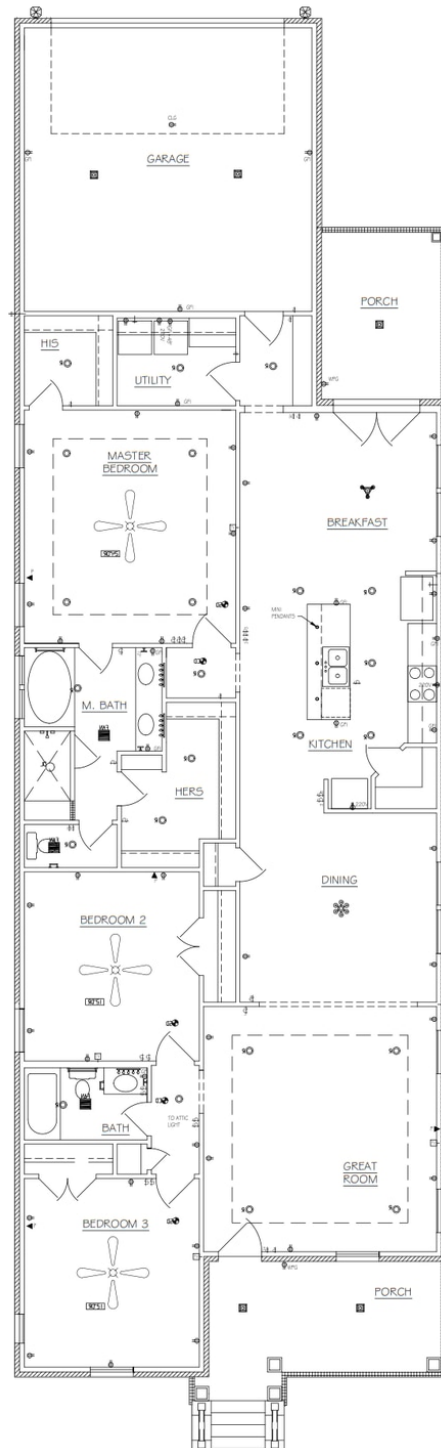

Prices, plans, dimensions, features, specifications, materials, and availability of homes or communities are subject to change without notice or obligation. Illustrations are artists depictions only and may differ from completed improvements. All prices subject to change without notice. Please contact your sales associate before writing an offer.